

# CENTRAL ELECTRIC

Jefferson City, MO

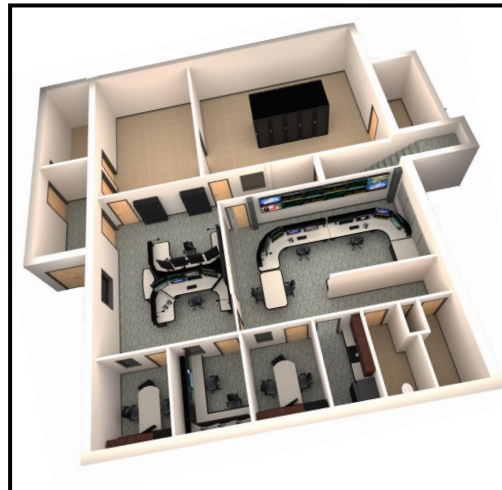

**L**amb provided Planning, Detail Design, and Construction Phase Services for the renovation of this 1,600 S.F. Control Room.

The Control Center is comprised of two separate user groups: Transmission and Energy Service Coordination, each with their own function and operational requirements.

The Transmission area features two sit-to-stand operator positions and a 2x6 array of 46" narrow-bezel LCD screens, which display SCADA, TV, and Security Feeds.

The Energy Service Coordinator area includes two operator positions and large-format screens for general overview and situational awareness.



*Robert E. Lamb, Incorporated*

*Planning Design Construction*